



## DOW FILMTEC™ TW30-1812-24

### Description

DOW FILMTEC™ reverse osmosis (RO) membranes for home drinking water treatment units are some of the most reliable and consistent elements in the industry. Advanced membrane technology and precision manufacturing allow Dow to precisely produce each and every element to tight, pre-defined specifications. Dow's advanced and consistent RO element quality helps customers develop, and maintain brand recognition along with a reputation for building systems that can reliably provide low impurity drinking water. DOW FILMTEC elements are shipped dry for convenient handling and long shelf-life.

### Product Type

Spiral-wound element with polyamide thin-film composite membrane

### Product Specifications

DOW FILMTEC™ Element	Applied Pressure		Permeate Flow Rate		Typical Stabilized Salt Rejection (%)
	(psig)	(bar)	(GPD)	(L/h)	
TW30-1812-24	50	3.4	24	3.8	98

1. Permeate flow and salt rejection based on the following test conditions: 250 ppm softened tap water, 77°F (25°C), 15% recovery and the specified applied pressure.
2. Minimum salt rejection is 96.0%.
3. Permeate flows for individual elements may vary ±20%.

### Element Dimensions



#### COMPONENT

This component is Tested and Certified by NSF International against NSF/ANSI Standard 58 for material requirements only.

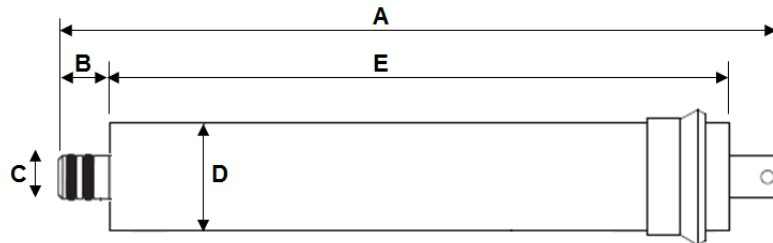

DOW FILMTEC™ Element	A		B		C		D		E	
	(in.)	(mm.)	(in.)	(mm)	(in.)	(mm)	(in.)	(mm)	(in.)	(mm)
TW30-1812-24	11.74	298	0.875	22.2	0.68	17	1.75	44.5	9.98	253.5

1. TW30-1812 Home Drinking Water elements seal at a standard 2.0 inch – 2.05 inch I.D. within pressure vessels

### Operating and Cleaning Limits

Maximum Operating Temperature	113°F (45°C)
Maximum Operating Pressure	150 psig (10 bar)
Maximum Feed Flow Rate	2.0 gpm (7.6 lpm)
pH Range, Continuous Operation	2 – 11
Maximum Feed Silt Density Index (SDI)	SDI 5
Free Chlorine Tolerance <sup>a</sup>	< 0.1 ppm

<sup>a</sup> Under certain conditions, the presence of free chlorine and other oxidizing agents will cause premature membrane failure. Since oxidation damage is not covered under warranty, Dow Water & Process Solutions recommends removing residual free chlorine by pretreatment prior to membrane exposure. Please refer to technical bulletin ["Dechlorinating Feedwater"](#) for more information.

## Additional Important Information

- It is recommended that systems using these elements rinse the elements for 24 hours, prior to first use, to meet NSF/ANSI 58 Standard.
- The first full tank of permeate must be discarded. Do not use this initial permeate for drinking water or food preparation.
- Keep elements moist at all times after initial wetting.
- To control the spread of biological growth during prolonged system shutdowns, it is recommended that membrane elements be immersed in a preservative solution. Rinse out the preservative before use.
- The membrane shows some resistance to short-term attack by chlorine (hypochlorite). Continuous exposure, however, may damage the membrane and should be avoided.
- DOW FILMTEC™ Home Drinking Water Reverse Osmosis Elements may be covered under the DOW FILMTEC™ Reverse Osmosis and Nanofiltration Element Three-Year Prorated Limited Warranty, 609-35010-1006 extended to OEMs. Such Limited Warranty is non-transferable. Contact a Dow representative for more information.

If operating limits and guidelines given in this Product Information Bulletin are not strictly followed, the Limited Warranty will be null and void. The OEM is fully responsible for the effects of incompatible chemicals and lubricants on elements. Use of any such chemicals or lubricants will void the Limited Warranty.

## Regulatory Note

These membranes may be subject to drinking water application restrictions in some countries; please check the application status before use and sale.

## Product Stewardship

Dow has a fundamental concern for all who make, distribute, and use its products, and for the environment in which we live. This concern is the basis for our product stewardship philosophy by which we assess the safety, health, and environmental information on our products and then take appropriate steps to protect employee and public health and our environment. The success of our product stewardship program rests with each and every individual involved with Dow products—from the initial concept and research, to manufacture, use, sale, disposal, and recycle of each product.

## Customer Notice

Dow strongly encourages its customers to review both their manufacturing processes and their applications of Dow products from the standpoint of human health and environmental quality to ensure that Dow products are not used in ways for which they are not intended or tested. Dow personnel are available to answer your questions and to provide reasonable technical support.

### For more information, contact Customer Information Group:

North America: 1-800-447-4369  
Latin America: +55-11-5184-8722  
Europe, Africa, Middle East: +31-115-672-626  
Asia Pacific: +86-21-3851-4988

[www.dowwaterandprocess.com](http://www.dowwaterandprocess.com)

Notice: The use of this product in and of itself does not necessarily guarantee the removal of cysts and pathogens from water. Effective cyst and pathogen reduction is dependent on the complete system design and on the operation and maintenance of the system.

**NOTICE:** No freedom from infringement of any patent owned by Dow or others is to be inferred. Because use conditions and applicable laws may differ from one location to another and may change with time, Customer is responsible for determining whether products and the information in this document are appropriate for Customer's use and for ensuring that Customer's workplace and disposal practices are in compliance with applicable laws and other government enactments. The product shown in this literature may not be available for sale and/or available in all geographies where Dow is represented. The claims made may not have been approved for use in all countries. Dow assumes no obligation or liability for the information in this document. References to "Dow" or the "Company" mean the Dow legal entity selling the products to Customer unless otherwise expressly noted. NO WARRANTIES ARE GIVEN; ALL IMPLIED WARRANTIES OF MERCHANTABILITY OR FITNESS FOR A PARTICULAR PURPOSE ARE EXPRESSLY EXCLUDED. All information set forth herein is for informational purposes only. This information is general information and may differ from that based on actual conditions. Please note that physical properties may vary depending on certain conditions and while operating conditions stated in this document are intended to lengthen product lifespan and/or improve product performance, it will ultimately depend on actual circumstances and is in no event a guarantee of achieving any specific results. Nothing in this document should be treated as a warranty by Dow.

